

Circular Road,  
Roscommon. F42 DY02.  
30/01/2024

Roscommon Co. Council,  
Planning Section,  
County Hall,  
Roscommon.

Ref: Submission re Roscommon Town Local Area Plan 2024 – 2030

I, Sean Doyle wish to have the lands shown on the attached map No. 2110-2, zoned in the Roscommon Town Local Area Plan 2024 – 2030 under Strategic Industrial/Enterprise.

The lands are fully serviced with both sewer and water mains.

An operational Re-Cycle Centre exists adjacent to these lands.

I am very interested in developing Advance Industrial Units at this site as soon as possible, as no such Units exist around Roscommon Town at present.

Land Details: Plot 1 - Folio No. 21442, Area 6.06 ha.

Plot 2 – Folio No. RN 38906F, Area 3.44 ha.

Plot 3 – Folio No. RN 23095, Area 3.30 ha.

Total Area: 12.8 ha.

Townland: Roxborough.

Signed: 

Sean Doyle

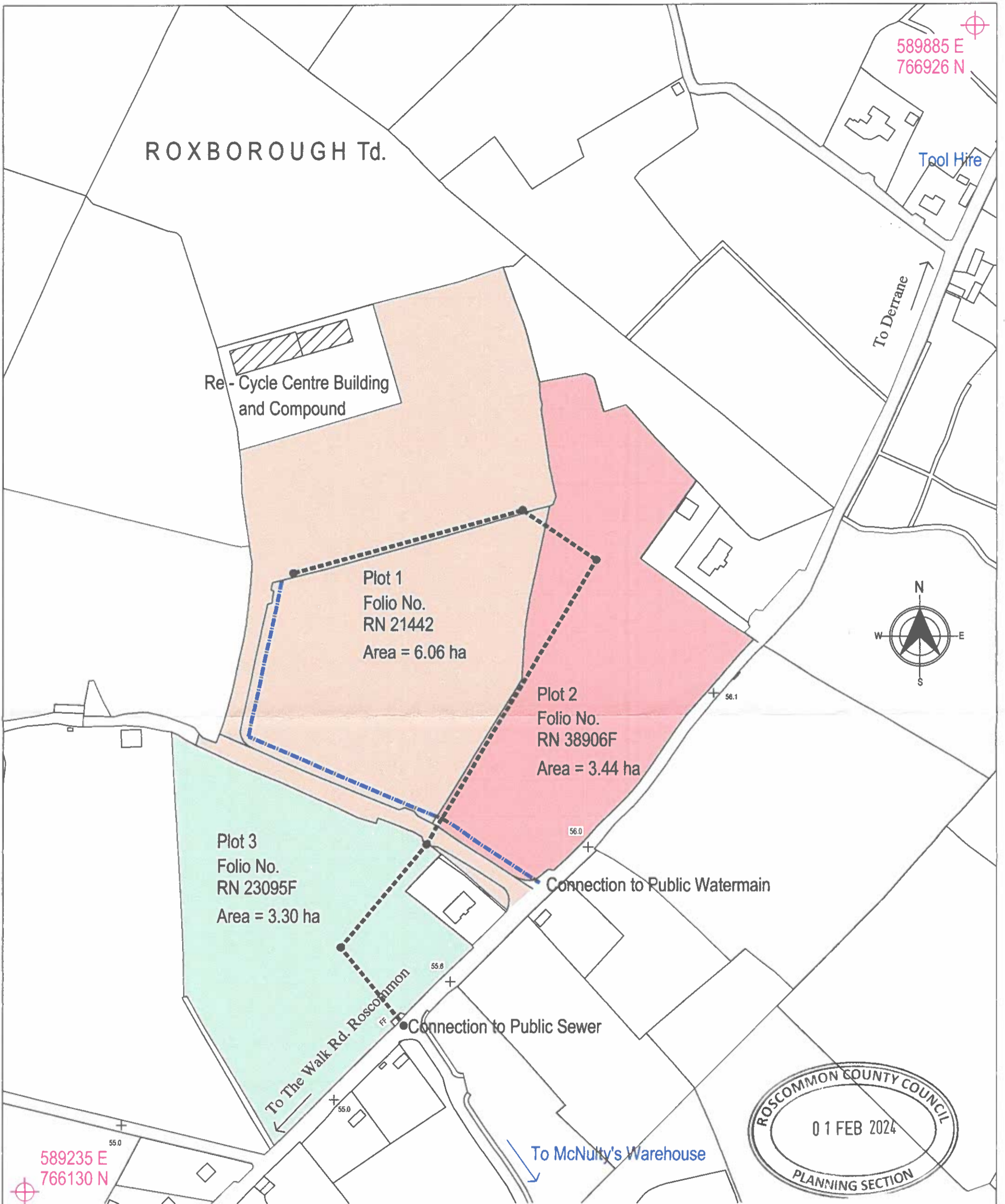

**INDEX:**

Existing Foul Sewer



Existing Watermain



project			
LANDS FOR ZONING AT ROXBOROUGH, ROSCOMMON, Co. ROSCOMMON.			
prepared			
client	SEAN DOYLE	dwg. no.	2110-2
title	SITE LOCATION PLAN		sheet no.
date	Jan. 2024	revision	scale 1:2,500
			1